

Conquer fuse clips are professional designed for varies of circuits and fusing applications. These clips are available in several finishing's and base materials which meet specific current, strength, and conductivity requirements.

CQ-301B

For 3.6mm Dia. Fuses

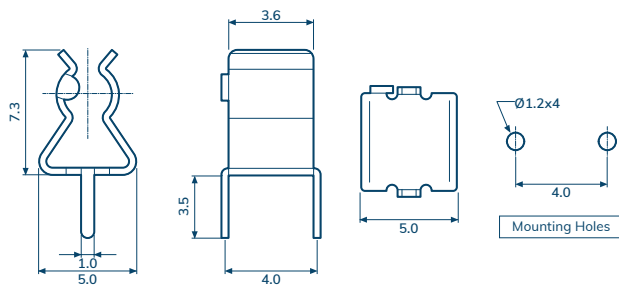

CQ-203B

For 5mm Dia. Fuses

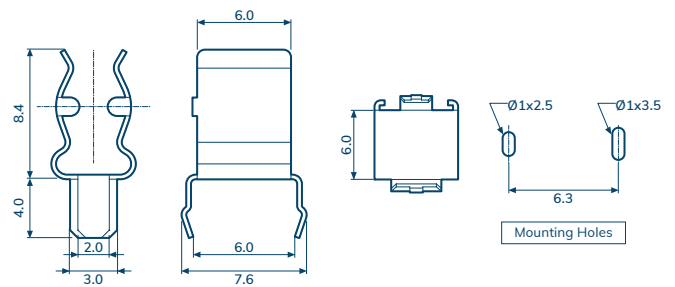

CQ-203E

For 5mm Dia. Fuses

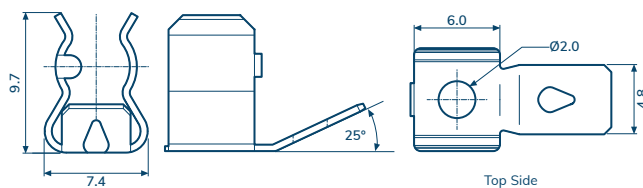

CQ-203H

For 5mm Dia. Fuses

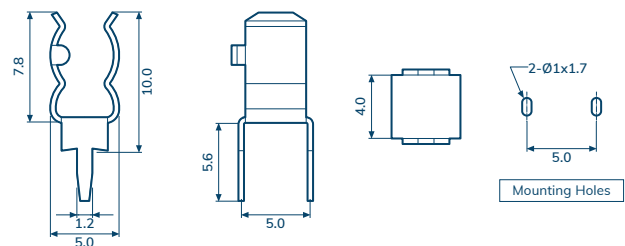

Item Number	CQ-301B	CQ-203B	CQ-203E	CQ-203H
Metal Material	Brass	Phosphor Bronze	Phosphor Bronze	Brass
Material Thickness	0.4 mm	0.3 mm	0.5 mm	0.4 mm
Suitable Rated Current	10 A	10 A	15 A	10 A
Fuse Type	Ear Type	Ear Type	Ear Type	Ear Type
Plating Type	Bright Tin Plated	Bright Tin Plated	Bright Tin Plated	Bright Tin Plated

CQ-203LR

For 5mm Dia. Fuses

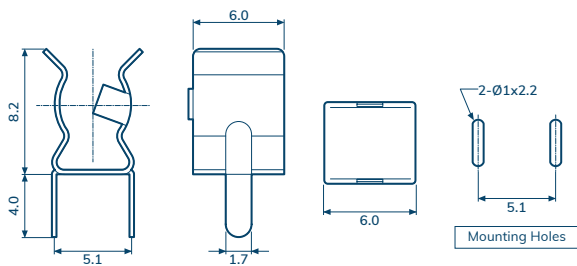
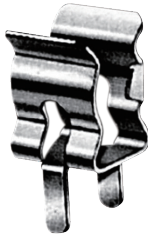
**RoHS****CQ-203P**

For 5mm Dia. Fuses

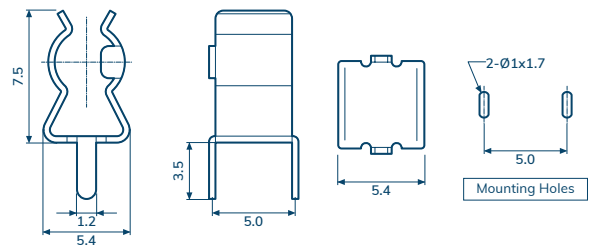
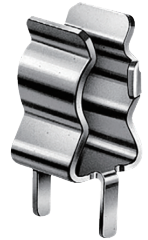
**RoHS****CQ-203S**

For 5mm Dia. Fuses

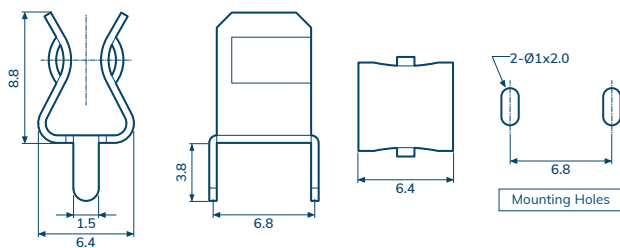
**RoHS****CQ-203SF(C)**

For 5mm Dia. Fuses

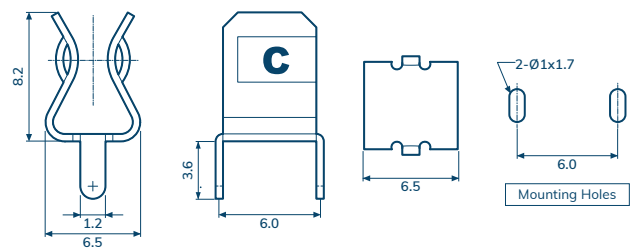
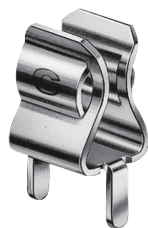
**RoHS**

Item Number	CQ-203LR	CQ-203P	CQ-203S	CQ-203SF(C)
Metal Material	Phosphor Bronze	Brass	Brass	Brass
Material Thickness	0.3 mm	0.4 mm	0.5 mm	0.4 mm
Suitable Rated Current	10 A	10 A	15 A	10 A
Fuse Type	Ear Type	Ear Type	Ear Type	Ear Type
Plating Type	Bright Tin Plated	Bright Tin Plated	Bright Tin Plated	Bright Tin Plated

Conquer fuse clips are professional designed for varies of circuits and fusing applications. These clips are available in several finishing's and base materials which meet specific current, strength, and conductivity requirements.

CQ-203SP

For 5mm Dia. Fuses

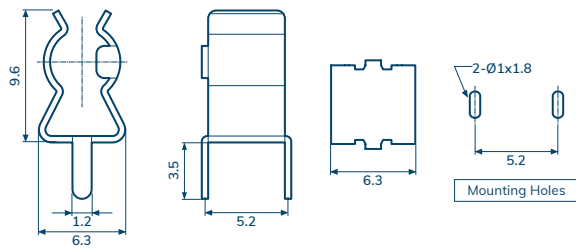

CQ-203T

For 5mm Dia. Fuses

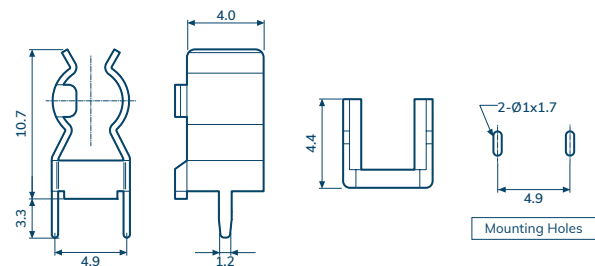

CQ-205B

For 6.3mm Dia. Fuses

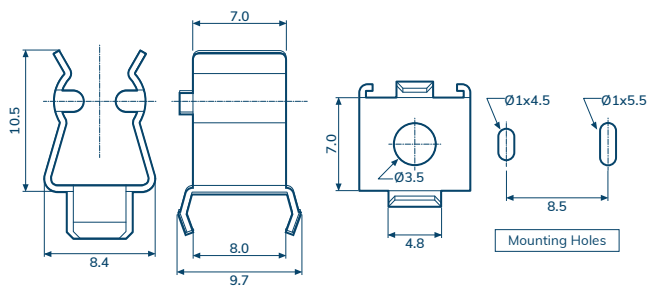

CQ-205D

For 6.3mm Dia. Fuses

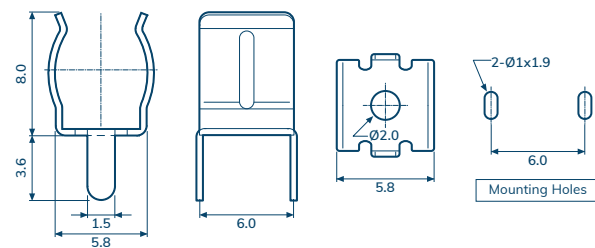

Item Number	CQ-203SP	CQ-203T	CQ-205B	CQ-205D
Metal Material	Brass	Brass	Brass	Brass
Material Thickness	0.4 mm	0.4 mm	0.5 mm	0.4 mm
Suitable Rated Current	10 A	10 A	15 A	15 A
Fuse Type	Ear Type	Ear Type	Ear Type	Earless Type
Plating Type	Bright Tin Plated	Bright Tin Plated	Bright Tin Plated	Bright Tin Plated

CQ-205E

For 6.3mm Dia. Fuses

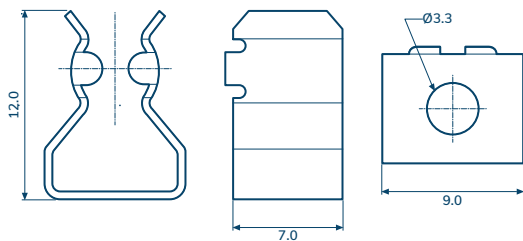

CQ-205DH

For 6.3mm Dia. Fuses

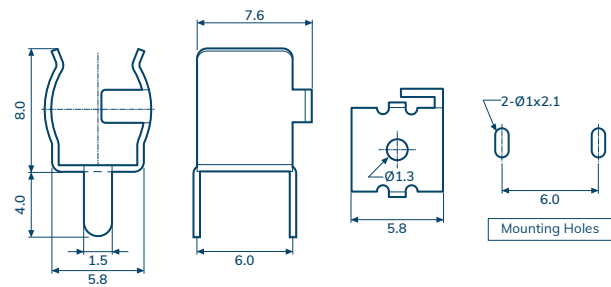

CQ-205S

For 6.3mm Dia. Fuses

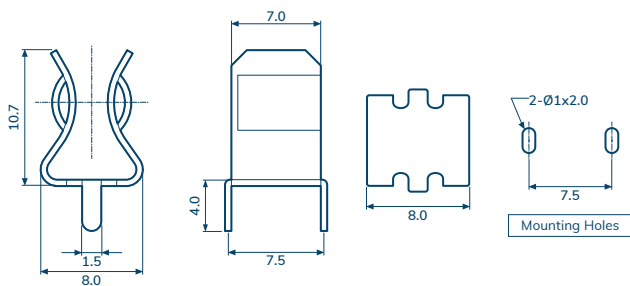

CQ-205SPP

For 6.3mm Dia. Fuses

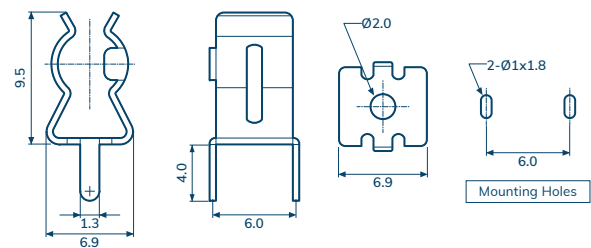

Item Number	CQ-205E	CQ-205DH	CQ-205S	CQ-205SPP
Metal Material	Phosphor Bronze	Phosphor Bronze	Brass	Phosphor Bronze
Material Thickness	0.5 mm	0.4 mm	0.5 mm	0.5 mm
Suitable Rated Current	15 A	15 A	25 A	15 A
Fuse Type	Ear Type	Ear Type	Ear Type	Ear Type
Plating Type	Bright Tin Plated	Bright Tin Plated	Bright Tin Plated	Bright Tin Plated

Conquer fuse clips are professional designed for varies of circuits and fusing applications. These clips are available in several finishing's and base materials which meet specific current, strength, and conductivity requirements.

CQ-111

For Blade
Auto Fuse ATQ Type

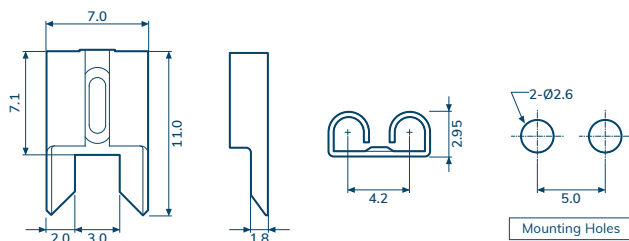

CQ-112

For AST
Mini Blade Type Fuse

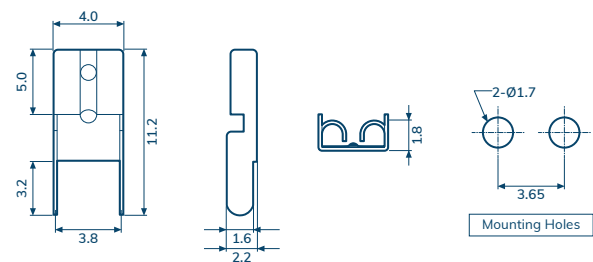

CQ-114

For ATQ Blade
Horizontal Clip

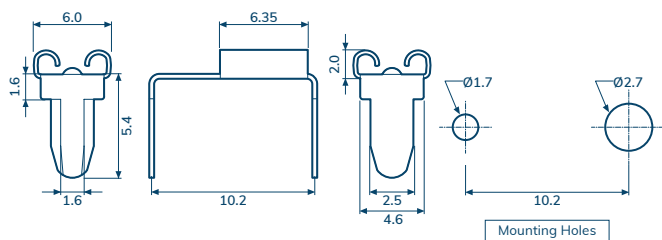
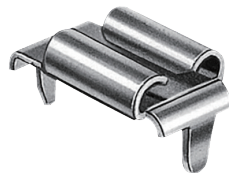

CQ-115

For AST
Mini BladeType Fuse

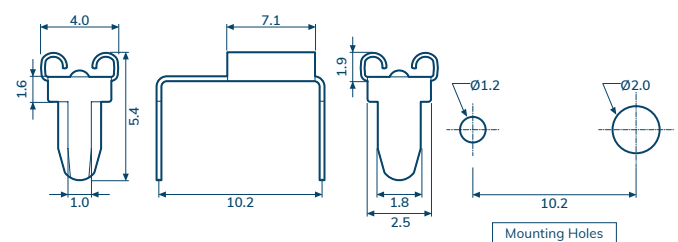

Item Number	CQ-111	CQ-112	CQ-114	CQ-115
Metal Material	Brass	Brass	Brass	Brass
Material Thickness	0.35 mm	0.3 mm	0.3 mm	0.3 mm
Suitable Rated Current	15 A	20 A	15 A	15 A
Fuse Type	ATQ Type	AST Type	ATQ Type	AST Type
Plating Type	Bright Tin Plated	Bright Tin Plated	Bright Tin Plated	Bright Tin Plated

CQ-05CT

Tape / Reel
For 5mm Dia. Fuse

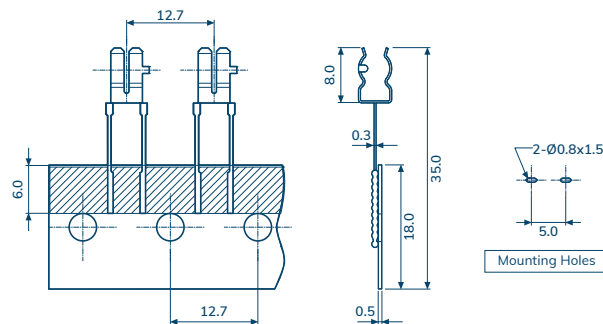

CQ-216

For 10.3mm Dia. Fuses

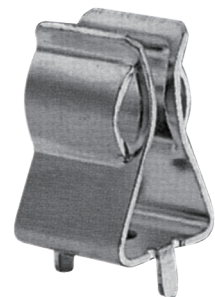
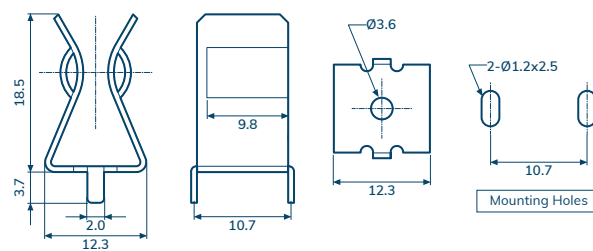

Item Number	CQ-05CT	CQ-216
Metal Material	Phosphor Bronze	Brass
Material Thickness	0.3 mm	0.7 mm
Suitable Rated Current	10 A	30 A
Fuse Type	Ear Type	Ear Type
Plating Type	Bright Tin Plated	Bright Tin Plated